

本图样仅供参考

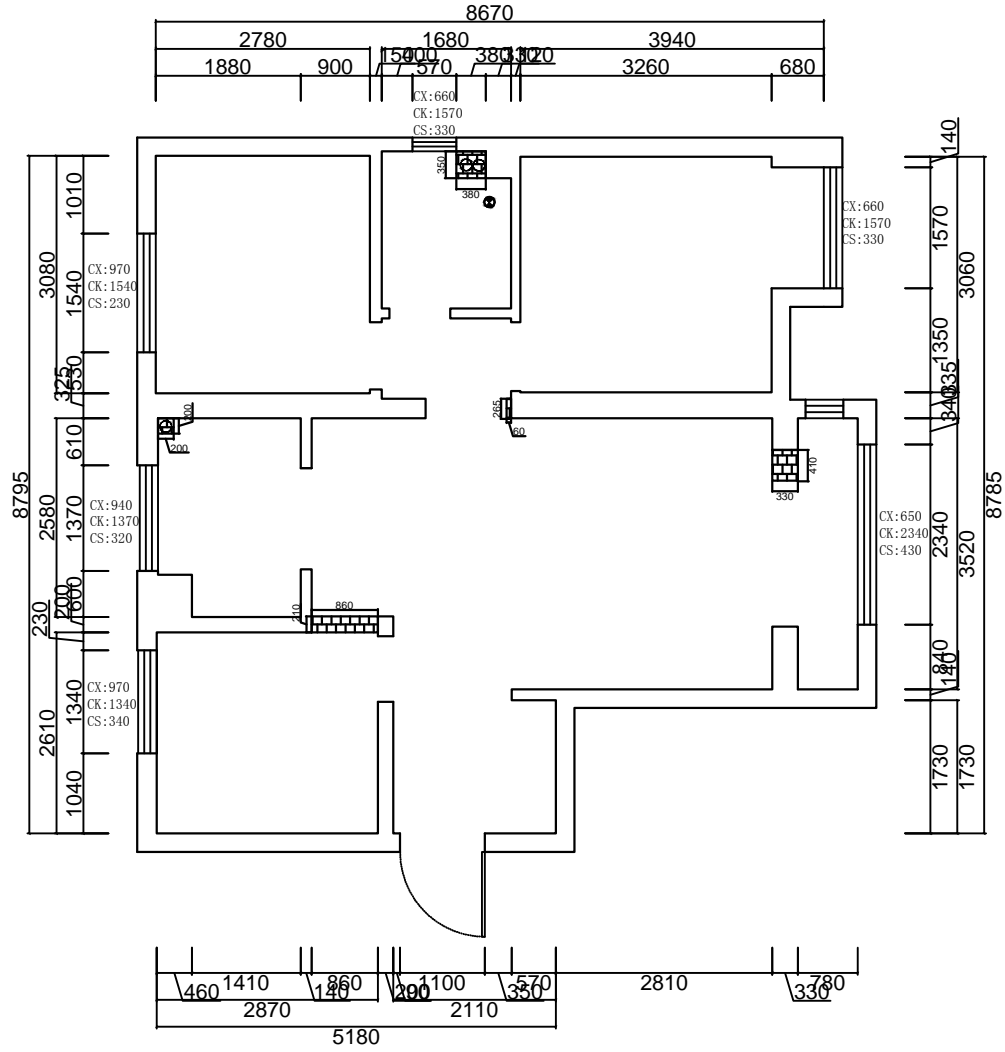

图例及说明: 1.  拆除墙体 2.  新建墙体

结构新建图 1:70



东易日盛 赛顿中心A6工作室

Dongyirisheng Expressly reserves its common law copyright and other property rights in these plans. These plans are not to be reproduced, changed or copied in any form or manner whatsoever. Nor are they to be assigned to any third party without first obtaining the expressed written permission and consent of Dongyirisheng.

东易日盛对本方案拥有版权及所有权。本方案不得以任何方式修改及复制。未经东易日盛书面授权, 本方案不得向任何第三方转让。

设计说明:
1: 平面标注尺寸为现场量取尺寸, 如有变化, 按实际;
2: 图纸布局原则上不做布局调整, 如有变化, 另行说明;
3: 双方(设计和甲方)签字认可后, 方可施工。

PROJECT:
工程名称: 水岸公馆三期1#1902

DRAWING TITLE:
图纸名称: 二层平面布局图

DESIGN BY:

DATE:
日期:

DRAWN BY:

DATE:
日期:

APPROVED BY:
审核员:

DATE:
日期:

CONSUMER:
客户:

DATE:
日期:

合同编号:

DRAWING NO:
图纸编号:
P-16

电话:
传真:
<http://www.dys.com.cn>